



Ningbo Dekon Refrigeration Equipment Co., Ltd



Add: F4,Fanya Center 18#,No.636 East Duantang Road,
Haishu district,Ningbo,China Post Code:315012



E-mail: dekon@dekon-hvac.com TEL: +86-574-88152763



www.dekon-china.com

Specifications subject to change without notice.

DRV Air Conditioner

Floor Ceiling Unit



Standard		Controller		
		Optional		
Wireless	Wireless	Wired	Wired	Centralized

Features

Accessories

Plenum box	Air filter	EXV	Drain pump	AC Motor	DC Motor
/	Standard	Standard (built-in)	Optional	Standard	/

Suspended installation, saves valuable floor space

- The use of ark effect: need to take up valuable floor position.
- The use of a hanging type indoor machine effect: Due to the adoption of a suspended installation, without occupying the ground position, will be valuable floor space to save up to add a set of dining table.



Wide angle air supply



- Configured with low noise high performance centrifugal fans, has big air flow and long distance air supply.

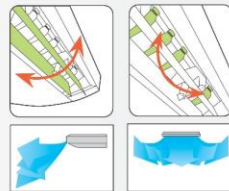

- 3 dimensional air supply, wide air supply angle, easily supply to every corners.

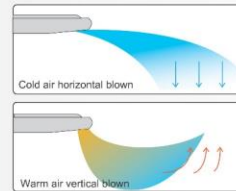

- In Cooling mode, cold air is blown from horizontal. In heating mode, warm air is blown from vertical.

Easy for installation

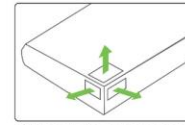

Refrigerant pipe can be connected from 3 directions.

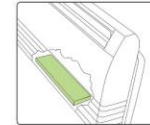

Electrical control box is in the rear of fan wheel casing, easy to remove, convenient for maintenance.

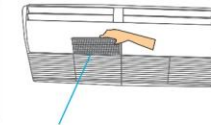

long term filter can be removed from air inlet grille to clean

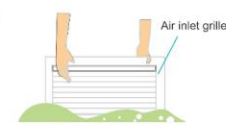

Water washable

Specification

Model name	Power type	Capacity				Motor input	Air flow	Sound Level	ESP	Dimension (W*H*D)				Body Weight		Connecting pipe			Standard controller	
		Cooling kW	Heating kW	Cooling kW	Heating kW					Packing mm	Body mm	packing mm	Panel mm	Net kg	Gross kg	Gas mm	Liquid mm	Drain mm		
V4SLDHR1-B	50Hz	4.5	15.3	5.0	17	0.06	950	550	37-46	/	1325*770*330	1245*680*240	/	/	/	/	/	/	/	/
V4SLDHR1-B	60Hz	4.5	15.3	5.0	17	0.06	950	550	37-46											
V5SLDHR1-B	50Hz	5.6	19.1	6.3	21.4	0.15	1300	780	39-48											
V5SLDHR1-B	60Hz	5.6	19.1	6.3	21.4	0.15	1300	780	39-48											
V7SLDHR1-B	50Hz	7.1	24.2	8.0	27.2	0.26	2300	1350	45-52											
V7SLDHR1-B	60Hz	7.1	24.2	8.0	27.2	0.26	2300	1350	45-52											
V8SLDHR1-B	50Hz	8.0	27.2	8.8	30	0.40	1500	880	44-50											
V8SLDHR1-B	60Hz	8.0	27.2	8.8	30	0.40	1500	880	44-50											
V9SLDHR1-B	50Hz	9.0	30.7	10.0	34.1	0.40	1500	880	44-50											
V9SLDHR1-B	60Hz	9.0	30.7	10.0	34.1	0.40	1500	880	44-50											
V11SLDHR1-B	50Hz	11.2	38.2	12.5	42.6	0.26	2300	1350	45-52											
V11SLDHR1-B	60Hz	11.2	38.2	12.5	42.6	0.26	2300	1350	45-52											
V14SLDHR1-B	50Hz	14.0	47.7	15	51.1	0.26	2300	1350	45-52											
V14SLDHR1-B	60Hz	14.0	47.7	15	51.1	0.26	2300	1350	45-52											
V16SLDHR1-B	50Hz	16.0	54.5	17	58	0.26	2300	1350	45-52											
V16SLDHR1-B	60Hz	16.0	54.5	17	58	0.26	2300	1350	45-52											

- Notes: 1. Power supply: 220-240V/1PH for 50Hz, 208-230V/1PH for 60Hz.
 2. Cooling test condition: indoor side 27°C DB, 19°C WB outdoor side 35°C DB, Heating test condition: indoor side 20°C DB, 15°C WB outdoor side 7°C DB.
 3. Sound level measured at a point 1 m in front of the unit at a height of 1.5 m. During actual operation, these values are normally somewhat higher as a result of ambient conditions.
 4. The above data may be changed without notice for future improvement on quality and performance.

